

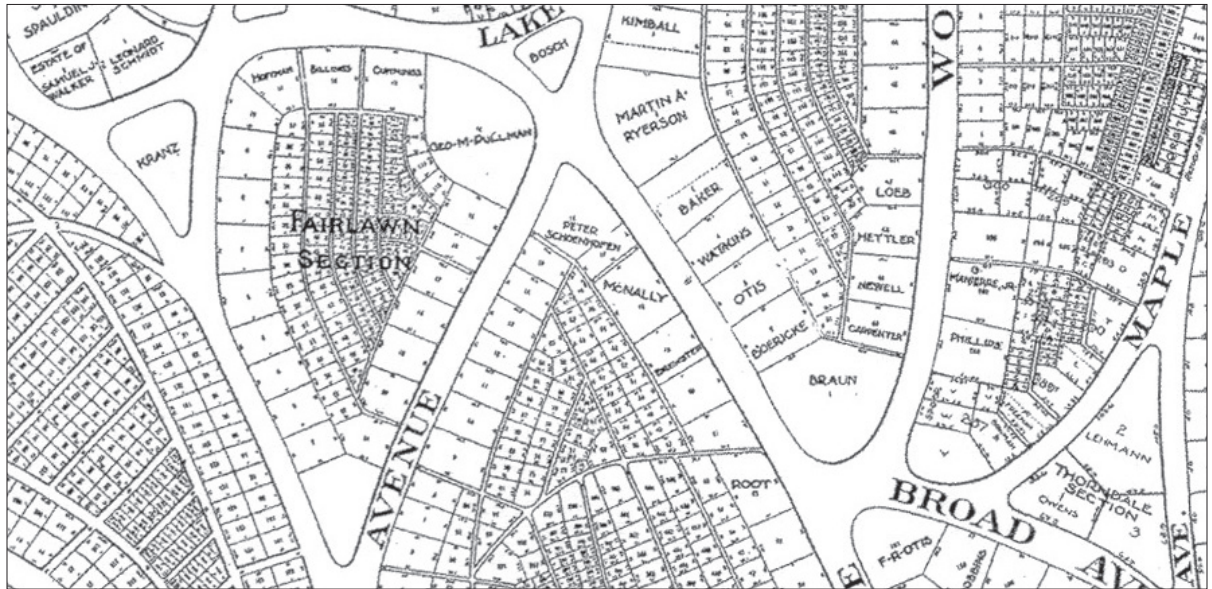

Design Evanston “Long views” at Graceland

A presentation and tour of Graceland Cemetery's landscape.



Graceland Cemetery is historically significant for its landscape design as well as one of the most intact surviving works of Ossian Cole Simonds. In his work in Graceland, Simonds relied on native plantings to create a naturalistic landscape, and he shaped vistas to provide what he called “long views.”

Meet landscape architect and DE member, Craig Soncrant of Wolff Landscape Architecture. Wolff has been the landscape architect at Graceland Cemetery for over 20 years - extensively involved in the restoration of the grounds in the spirit of Simonds and, where possible, to his exact specifications. Craig will talk about Wolff's plans for Graceland and lead a tour of some of the significant landscape and architectural features of the cemetery.

10:30am, Saturday, October 12, 2013 (Main Gate, 4001 North Clark Street)

Join us afterward at Common Ground, 3800 N. Clark Street for an informal lunch and discussion.

(Please park on Clark or Irving Park)

DE Members: Free, Non-Members: \$5

RSVP by October 7 www.designevanston.org/events